

FEATURES

- High CRI LED optimized towards TM30

- ENEC approved drivers

- Max. 3 downlights can be connected to 1 driver

- Easy installation by Plug & Play system available



Reflector
L4CS 24° / 60°



Diffuser
L4CS 80°



SPRINGS
Standard with GS spring (concrete/
gyproc). Also available as above with
WS spring (gyproc/metal).



COLOURS
Available colours:

Matt white RAL 9016 (XX=MW)
Matt black RAL 9005 (XX=BL)

Linea 185 L4CS

Fixed

SPECIFICATIONS

Beam angle (FWHM)	24° / 60° / 80°
Fixture material	Housing: Die cast aluminium / Reflector glass: Polycarbonate
Environment	Indoor
IK rate	IK03
Operating temperature (Ta)	-20°C / +45°C
Safety marks	EN60598 / EN62031 / EN62471
EMC compliance	EN55015
Colour consistency (SDCM)	MacAdam step 3
Warranty	7 years * (within the European Union and the countries of the Free Trade Association for products delivered after 1 May 2015)
Safety class	III
Energy class	To be determined

This luminaire contains built-in LED lamps. There are no exchangeable parts inside the luminaire. EU 874/2012

MADE IN HOLLAND

7 YEAR WARRANTY

ECO

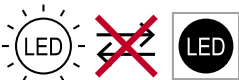

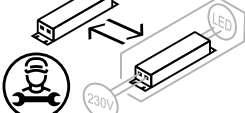

Only when the product is installed in a closed ceiling it may be exposed to water splashes, and only on its front side.

IP20

IP65

LINEA 185 L4CS

Max 1050 mA



ITEM SPECIFICATIONS

Description	Item code GS	WS	Input	Vf	W	Lm	Lm/W	CRI (typ.)	UGR	Pf	Ripple	Inrush current	B-16A Fuse	Safety class
Linea 185 L4CS max 2250Lm 2700K 24°	877A03XX2UE2	877A03XX9KE2	max 1050mA	18,2	19,1	2250	118	93	19,9	x	x	x	x	III
Linea 185 L4CS max 2400Lm 3000K 24°	877B03XX2UE2	877B03XX9KE2	max 1050mA	18,2	19,1	2400	126	93	20,2	x	x	x	x	III
Linea 185 L4CS max 2575Lm 4000K 24°	877E03XX2UE2	877E03XX9KE2	max 1050mA	18,2	19,1	2575	135	93	20,4	x	x	x	x	III
Linea 185 L4CS max 2250Lm 2700K 60°	877A03XX2VE2	877A03XX9LE2	max 1050mA	18,2	19,1	2250	118	93	20,8	x	x	x	x	III
Linea 185 L4CS max 2400Lm 3000K 60°	877B03XX2VE2	877B03XX9LE2	max 1050mA	18,2	19,1	2400	126	93	21,0	x	x	x	x	III
Linea 185 L4CS max 2575Lm 4000K 60°	877E03XX2VE2	877E03XX9LE2	max 1050mA	18,2	19,1	2575	135	93	21,3	x	x	x	x	III
Linea 185 L4CS max 2250Lm 2700K 80°	877A03XX2WE2	877A03XX9ME2	max 1050mA	18,2	19,1	2250	118	93	25,3	x	x	x	x	III
Linea 185 L4CS max 2400Lm 3000K 80°	877B03XX2WE2	877B03XX9ME2	max 1050mA	18,2	19,1	2400	126	93	25,5	x	x	x	x	III
Linea 185 L4CS max 2575Lm 4000K 80°	877E03XX2WE2	877E03XX9ME2	max 1050mA	18,2	19,1	2575	135	93	25,7	x	x	x	x	III

Description	Energy class	Weight	Dimensions carton	Quantity per carton	Expected Lifetime			Reported Lifetime*		
					L70B10	L80B10	L90B10	L70B10	L80B10	L90B10
Linea 185 L4CS max 2250Lm 2700K		540 gr	233x233x85 mm	20 pcs	>465.000 hrs	>274.000 hrs	103.000 hrs	>105.000 hrs	>105.000 hrs	103.000 hrs
Linea 185 L4CS max 2400Lm 3000K		540 gr	233x233x85 mm	20 pcs	>465.000 hrs	>274.000 hrs	103.000 hrs	>105.000 hrs	>105.000 hrs	103.000 hrs
Linea 185 L4CS max 2575Lm 4000K		540 gr	233x233x85 mm	20 pcs	>465.000 hrs	>274.000 hrs	103.000 hrs	>105.000 hrs	>105.000 hrs	103.000 hrs

All values are measured at 230V (+/- 7%). *Based on 19.000hrs of LM80 testing at 180mA per die and a Tc85°C.

CHOOSE YOUR LV LUMEN OUTPUT

	mA	3 spots		Lumen Output			Lumen / Watt			Advised PSU	
		Vf	W	2700K	3000K	4000K	2700K	3000K	4000K	No dim	Dali
Special request	350	49,5	17,3	800	850	900	139	147	156	127568	126566
Standard	500	50,4	25,2	1125	1200	1275	134	143	152	127568	126566
Special request	650	51,6	33,5	1400	1500	1600	125	134	143	127568	126566
Standard	800	52,8	42,2	1750	1850	1975	124	131	140	127568	126566
Standard	1050	54,6	57,3	2250	2400	2575	118	126	135	127568	126566

DIMENSIONS

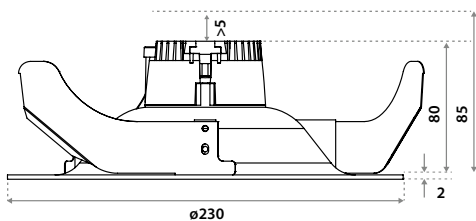

CUT OUT



Using GS springs: Ø 170-175 mm.
Thickness ceiling 8-85 mm & recess depth 85 mm. For plasterboard ceilings or similar harder materials. Turn the ring on the front counterclockwise after installation.



Using WS springs. Ø 180-210 mm.
Thickness ceiling 1-35 & recess depth 85 mm. For soft ceiling tiles. We recommend taking down the ceiling tile before installing the product.

PSU (INCL. L4CS CABLE SET 3L)



PSU 78W No dim TCI 127568
359x30x21 mm
Exp. lifespan 100.000 hrs
Incl. cable set 3L and wire grip



PSU 78W Dali TCI 126566
359x30x21 mm
Exp. lifespan 100.000 hrs
Incl. cable set 3L and wire grip

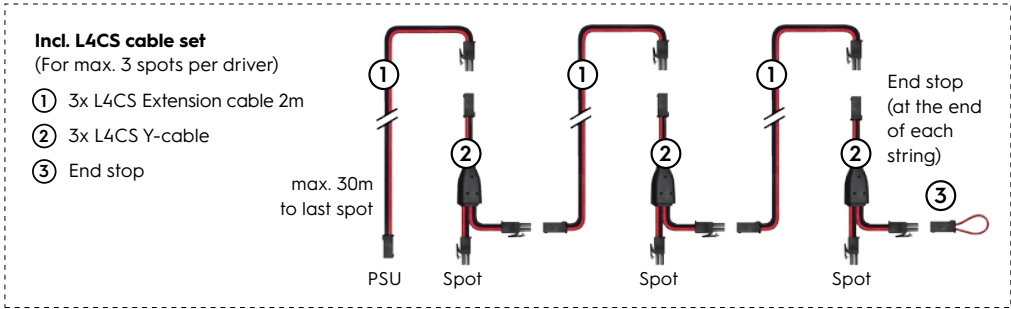

Item specifications (PSU)

Driver types	Supplier name	Item code	Input	W	Max mA	Max Vf	Pf	Eff.	Inrush current	B-16A Fuse
PSU 78W 500mA No dim TCI + L4CS cable set 3L	127568	05T103MLMA03	220-240V AC/DC	78W	350-1400	56	0.95	>91%	10A200µs	30 pcs
PSU 78W 500mA Dali TCI + L4CS cable set 3L	126566	05S803MLMA03	220-240V AC/DC	78W	350-1400	56	0.95	>91%	10A200µs	30 pcs
PSU 78W 800mA No dim TCI + L4CS cable set 3L	127568	05L703MLMA03	220-240V AC/DC	78W	350-1400	56	0.95	>91%	10A200µs	30 pcs
PSU 78W 800mA Dali TCI + L4CS cable set 3L	126566	05L903MLMA03	220-240V AC/DC	78W	350-1400	56	0.95	>91%	10A200µs	30 pcs
PSU 78W 1050mA No dim TCI + L4CS cable set 3L	127568	05M203MLMA03	220-240V AC/DC	78W	350-1400	56	0.95	>91%	10A200µs	30 pcs
PSU 78W 1050mA Dali TCI + L4CS cable set 3L	126566	05M303MLMA03	220-240V AC/DC	78W	350-1400	56	0.95	>91%	10A200µs	30 pcs

All values are measured at 230V (+/- 7%).

PLUG & PLAY CABLE SYSTEM 3/5P

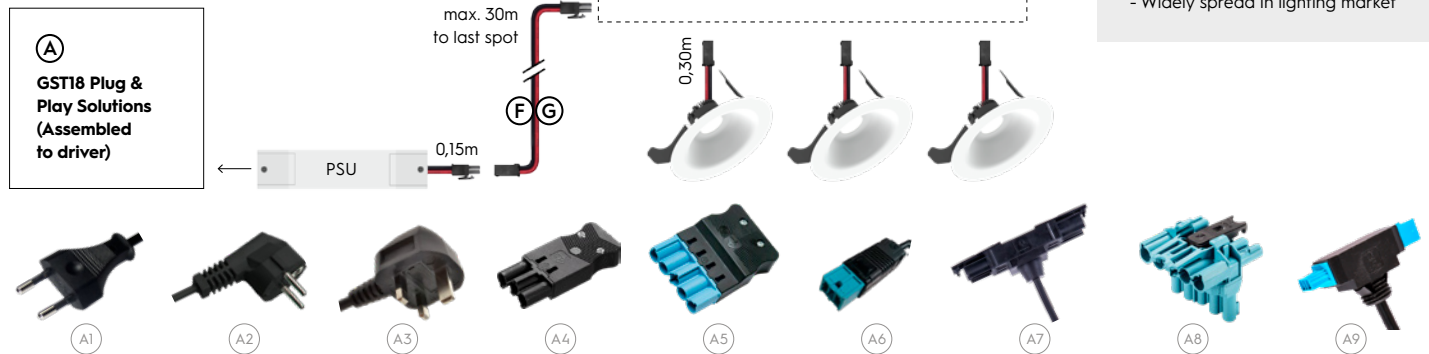

FEATURES

- Professional 16A Plug & Play system
- 3 or 5 wire system
- Widely spread in lighting market

Item specifications (accessories)

Description	Class	Length	Item code
(A1) Euro plug incl. cable	II	2.0 m	015203BL1200
(A2) Schuko plug incl. cable	I	1.5 m	1C5203BLA000
(A3) UK plug incl. cable	II	2.0 m	0A5203BL1200
(A4) 3P GST18 male incl. cable 2x0.75mm²	II	0.3 m	455203BL0000
(A4) 3P GST18 male incl. cable 2x0.75mm²	II	3.0 m	455203BL1500
(A4) 3P GST18 male incl. cable 3x0.75mm²	I	0.3 m	4A5203BL0000
(A4) 3P GST18 male incl. cable 3x0.75mm²	I	3.0 m	4A5203BL1500
(A5) 5P GST18 male 1-10V/Dali incl. cable 4x0.75mm²	II	0.3 m	655203BL0000
(A5) 5P GST18 male 1-10V/Dali incl. cable 4x0.75mm²	II	3.0 m	655203BL1500

Description	Class	Length	Item code
(A5) 5P GST18 male 1-10V/Dali incl. cable 5x0.75mm²	I	0.3 m	6A5203BL0000
(A5) 5P GST18 male 1-10V/Dali incl. cable 5x0.75mm²	I	3.0 m	6A5203BL1500
(A6) BST14i male Dali incl. cable	III	0.5 m	095203BL0000
(A6) BST14i male Dali incl. cable	III	3.0 m	095203BL1500
(A7) 3P GST18 T-splitter male incl. cable	II	0.2 m	459203BL0000
(A7) 3P GST18 T-splitter male incl. cable	I	0.2 m	4A9203BL0000
(A8) 5P GST18 T-splitter male 1-10V/Dali	I / II	x	659203BU0000
(A9) BST14i T-splitter male 1-10V/Dali incl. cable	III	0.2 m	099203BL0000

DISTRIBUTOR SYSTEM 2P*

*Not for Dali.

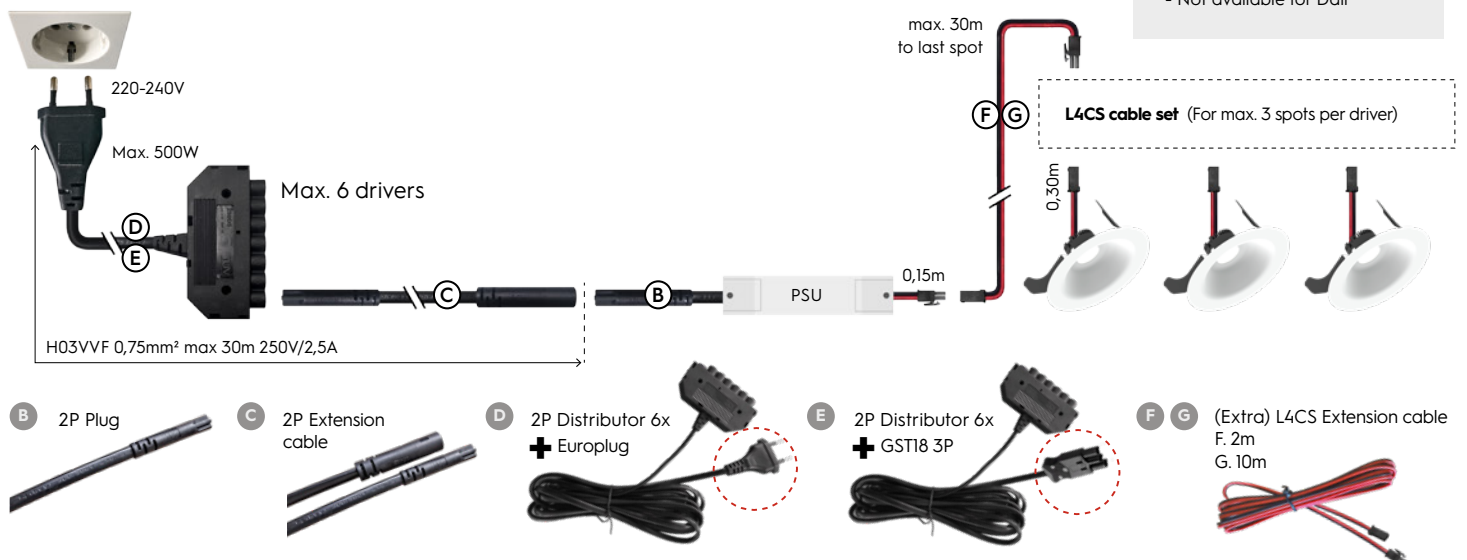

FEATURES

- Basic 2,5A Plug & Play system
- 2 wire system
- Not available for Dali

Item specifications (accessories)

Description	Specification	Class	Length	Item code
(B) 2P Plug 0,15m *	HV 0,15m male (0,75mm²)	II	0,15 m	6J5203BL1B02
(C) 2P Extension cable	HV Ø7,6mm 2m m/f (0,75mm²)	II	2.0 m	6F5203BL1202
(D) 2P Distributor 6x + Europlug	HV Ø7,6mm 6x + cable 3m 2,5A	II	3.0 m	665203BL2502
(E) 2P Distributor 6x + GST18 3P	HV Ø7,6mm 6x + cable 3m 2,5A	II	3.0 m	665203BL1502
(F) L4CS Extension cable 2m	LV 2m m/f (0,34mm²)	II	2.0 m	6B5203BL1202
(G) L4CS Extension cable 10m	LV 10m m/f (0,34mm²)	II	10.0 m	6E5203BL1202

*Assembled to driver, not for Dali drivers.

2700K

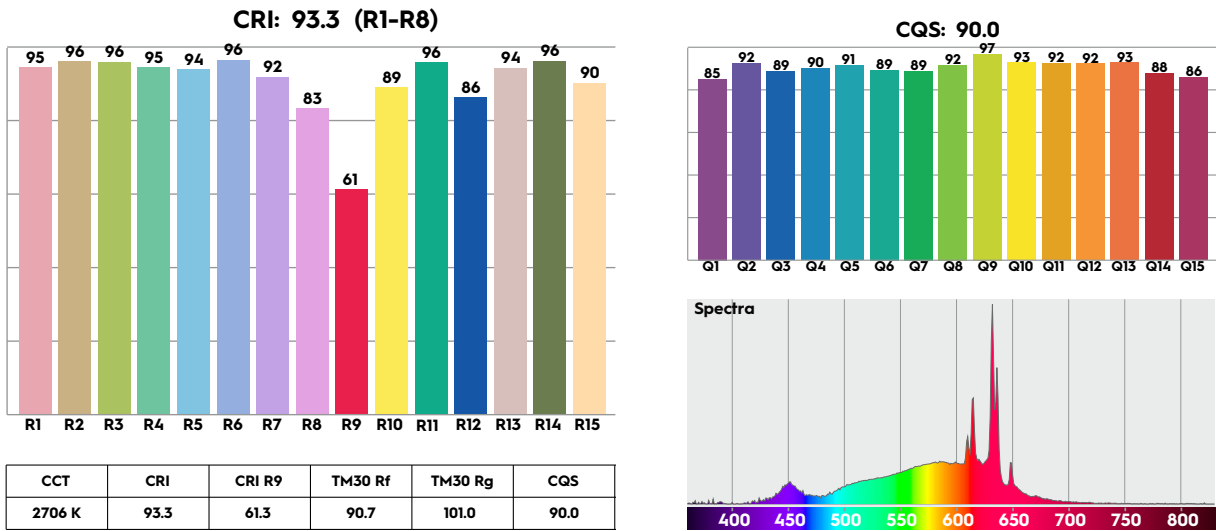

3000K

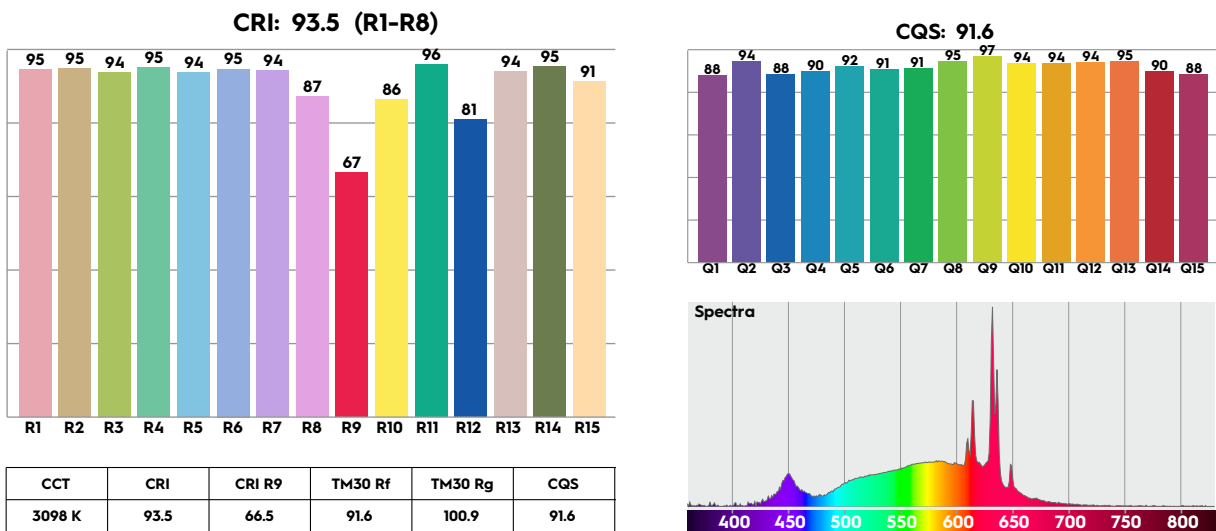

4000K

